

REV	DESCRIPTION	DESIGN	DATE
A	NEW RELEASE	Ryan	2021/10/22

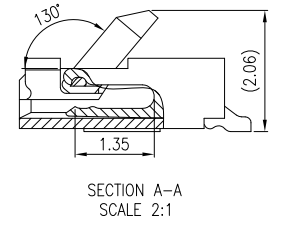
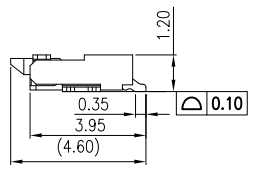
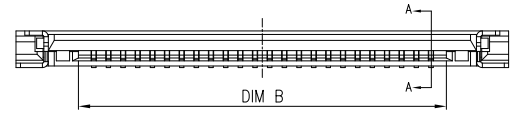
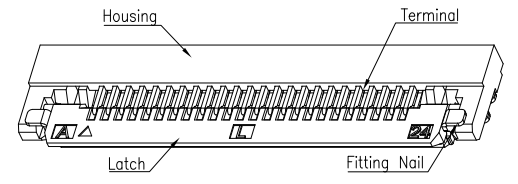

CKT	DIM A	DIM B	DIM C	DIM D	CKT	DIM A	DIM B	DIM C	DIM D
4	1.50	2.55	4.60	6.80	33	16.00	17.05	19.10	21.30
5	2.00	3.05	5.10	7.30	34	16.50	17.55	19.60	21.80
6	2.50	3.55	5.60	7.80	35	17.00	18.05	20.10	22.30
7	3.00	4.05	6.10	8.30	36	17.50	18.55	20.60	22.80
8	3.50	4.55	6.60	8.80	37	18.00	19.05	21.10	23.30
9	4.00	5.05	7.10	9.30	38	18.50	19.55	21.60	23.80
10	4.50	5.55	7.60	9.80	39	19.00	20.05	22.10	24.30
11	5.00	6.05	8.10	10.30	40	19.50	20.55	22.60	24.80
12	5.50	6.55	8.60	10.80	41	20.00	21.05	23.10	25.30
13	6.00	7.05	9.10	11.30	42	20.50	21.55	23.60	25.80
14	6.50	7.55	9.60	11.80	43	21.00	22.05	24.10	26.30
15	7.00	8.05	10.10	12.30	44	21.50	22.55	24.60	26.80
16	7.50	8.55	10.60	12.80	45	22.00	23.05	25.10	27.30
17	8.00	9.05	11.10	13.30	46	22.50	23.55	25.60	27.80
18	8.50	9.55	11.60	13.80	47	23.00	24.05	26.10	28.30
19	9.00	10.05	12.10	14.30	48	23.50	24.55	26.60	28.80
20	9.50	10.55	12.60	14.80	49	24.00	25.05	27.10	29.30
21	10.00	11.05	13.10	15.30	50	24.50	25.55	27.60	29.80
22	10.50	11.55	13.60	15.80	51	25.00	26.05	28.10	30.30
23	11.00	12.05	14.10	16.30	52	25.50	26.55	28.60	30.80
24	11.50	12.55	14.60	16.80	53	26.00	27.05	29.10	31.30
25	12.00	13.05	15.10	17.30	54	26.50	27.55	29.60	31.80
26	12.50	13.55	15.60	17.80	55	27.00	28.05	30.10	32.30
27	13.00	14.05	16.10	18.30	56	27.50	28.55	30.60	32.80
28	13.50	14.55	16.60	18.80	57	28.00	29.05	31.10	33.30
29	14.00	15.05	17.10	19.30	58	28.50	29.55	31.60	33.80
30	14.50	15.55	17.60	19.80	59	29.00	30.05	32.10	34.30
31	15.00	16.05	18.10	20.30	60	29.50	30.55	32.60	34.80
32	15.50	16.55	18.60	20.80					

Specifications:
 Housing:High temperature plastic UL94V-0;Color:natural
 Latch:High temperature plastic UL94V-0;Color:black
 Terminal:Copper alloy, Matte Tin/Gold
 Fitting Nail:Copper alloy, Matte Tin
 Product must comply HF RoHS specification
 Contact resistance:≤30mΩ
 Insulation resistance:≥100MΩ
 Rated voltage:50V AC/DC
 Rated current:0.5A AC/DC
 Withstand Voltage:250V AC/minute
 Temperature Range:-55°C~+105°C

ORDER INFORMATION:

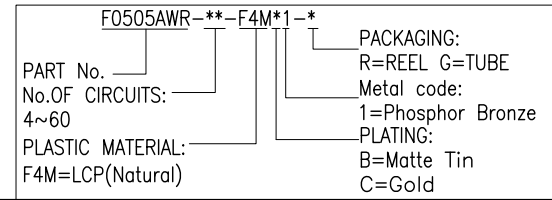

JKUN 温州健坤接插件有限公司
 WENZHOU JKUN CONNECTOR CO.,LTD.

GENERAL TOLERANCE	USE:
X.X ±0.15	CUSTOMER
X.XX ±0.10	APPD: Shaojinghe
X.XXX ±0.05	CHKD: Shaojinghe
UNITS: mm	DR: Ryan

TITLE:
 FPC Pitch0.5 H1.2 Front-Flip Conn. SMT Type

PART NO.:
 F0505AWR-**-F4M*1-*

DWG NO.:
 JKUN-GCKH-

SCALE: 1 : 1

SHEET: 1 / 1